

Lighting

We bring world-class, energy-efficient lighting systems to market – designed to improve wellbeing, optimise performance, and reduce environmental impact.



PHILIPS

©signify



Lighting

Lighting innovation with people at the centre.

RT Systems is proud to announce the launch of its new Lighting offering, created to deliver innovative and sustainable illumination solutions. In partnership with Signify (formerly Philips Lighting), we are combining our expertise with the global leader in lighting technology to bring intelligent, energy-efficient systems to market. This collaboration marks an exciting step forward in shaping brighter, smarter, and more sustainable environments for our customers.

PHILIPS

signify

RT Systems transforms light into more than illumination — it's about people, innovation, and sustainability. With 20+ years of expertise, we merge tradition with cutting-edge technology to deliver intelligent, eco-conscious solutions that help businesses thrive while supporting a brighter future for society and the environment.



Customer Benefits

LED Lighting
Systems

Energy-Saving
Solutions

Colour Control
Systems

Manual and
Automated Light
Management
System

Applications

Offices and
Professional
Workplaces

Educational
and Healthcare
Institutions

Distribution
Centers and
Warehousing

Outdoor and
Architectural
Lighting

* information available on request

■ Offices and professional workplaces

SlimBalance G3 SP570P

The SlimBalance G3 SP570P is a versatile linear solution designed for modern office and educational environments.

Flexible dimensions: Available in widths of 35 / 60 / 90 / 120 mm and lengths of 600 / 1200 / 1500 mm, enabling seamless integration across multiple applications.

Geometric design: Clean linear forms and geometric options support differentiated spatial layouts and architectural expression.

Optimised installation: Purpose-built structural design ensures fast, straightforward installation and simplified maintenance.

Advanced lighting performance: Equipped with BioUp LED technology, delivering improved MDER compared to standard LED spectra, while maintaining consistent visual color impression.

Visual comfort: UGR19 available through customised configurations, enhancing comfort and productivity in office environments.

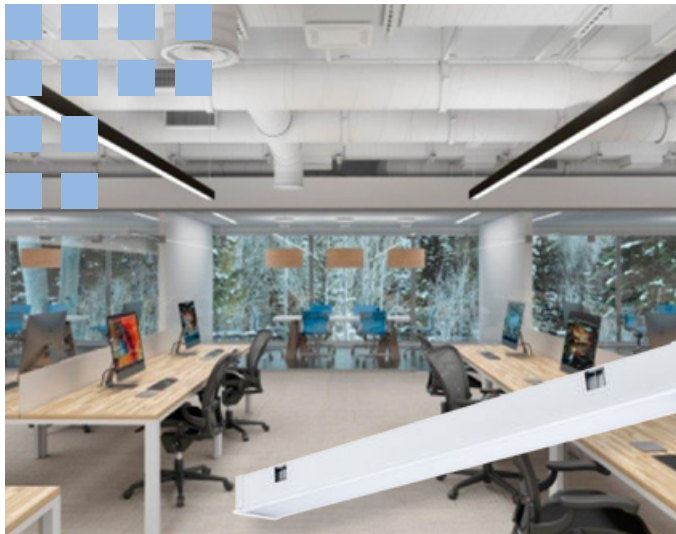

GreenPerform Panel RC099V G3

The GreenPerform Panel RC099V G3 is a cost-effective LED panel solution delivering comfortable, uniform illumination for office environments.

High efficiency: up to 140 lm/W performance for energy-conscious applications.

Multiple formats: available in 600×600 mm, 300×1200 mm, and 600×1200 mm sizes to suit diverse ceiling layouts.

Visual comfort: UGR19 option enhances workplace lighting quality and reduces glare.

Smart connectivity: compatible with DALI, Interact, and EcoSet systems, enabling seamless integration with building controls for improved energy savings.

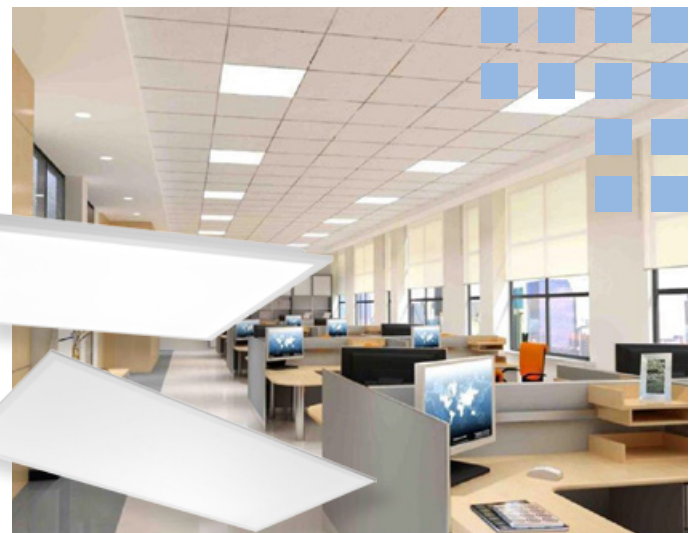

GreenSpace G6 LED Downlight

GreenSpace G6 extends the proven GreenSpace line with compact LED downlights engineered for efficiency and comfort. The recessed architecture with increased reflector depth ensures precise detail rendering and reduced glare.

- Compact housing with deep-set reflector for enhanced visual comfort.
- Wide lumen range: 600–3550 lm.
- Multiple variants: fixed, dimmable, Interact Ready.
- Unified design language across configurations for consistent aesthetics.
- Energy-saving LED technology with reliable performance.

Application scope

Ideal for projects requiring flexible lighting ambiances with a cohesive luminaire family. GreenSpace G6 supports broad deployment in commercial, retail, and hospitality environments where efficiency and comfort are critical.

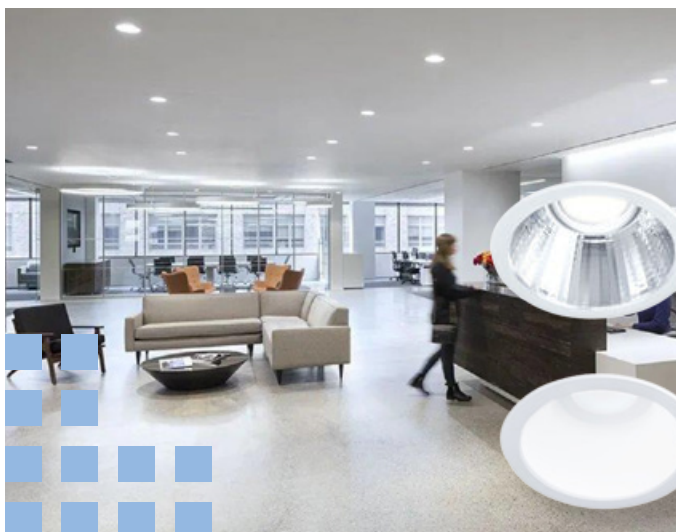



EcoSet Wireless – Highbay BY570 with PIR Sensor

The EcoSet Wireless Highbay BY570 with integrated PIR sensor extends the GreenPerform family's reputation for dependable performance. Engineered with optimised optics for Unified Glare Rating (UGR) control, it delivers high system efficiency, a compact form factor, and long-term reliability. Designed for industrial environments, the BY570 is fully compatible with IoT platforms, including Interact scalable systems.

Automatic energy saving: PIR motion detection, daylight harvesting, and step-dimming functions

High performance lighting: Up to 140 lm/W efficacy

Flexible options: Available in 3 sizes, 4 lumen packages, and 2 CCT variants

Key benefits

- Energy efficiency made simple: Automatic savings without complex setup
- Easy commissioning: No gateway, cloud, or app required
- Reduced installation costs: Integrated wireless sensor eliminates need for separate components



GreenPerform Sensor Waterproof G3 L1 W

- Wireless control: EcoSet sensor external wireless solution via BLE technology
- Driver: Integrated wireless driver
- Optics: Two types available for varied applications
- Efficacy: Up to 140 lm/W
- Lengths: 3 options
- Lumen packages: 5 options
- CCTs: 2 options
- Lifetime: 50,000 hours @ L70B50
- Temperature range: -20 °C to +45 °C
- Installation: Suspension or surface mount to ceiling

Applications

Canopy, food & beverage industry, parking garages, general industrial areas

GreenPerform Sensor Waterproof G3 L1 W is engineered for simple, wireless energy-saving control. Each luminaire integrates a wireless driver, enabling group control through BLE technology with external sensors or remote controllers.

Features & benefits

- Energy efficiency: Seamless wireless control for reduced energy consumption
- Lighting performance: High efficacy with multiple lengths, lumen packages, and CCT options
- Durability: Long lifetime and wide operating temperature range for demanding environments
- Versatility: Two optical designs tailored to different applications
- Ease of installation: Flexible mounting options for quick deployment



Distribution Centers and Warehousing



GreenPerform Highbay G5

The GreenPerform Highbay G5 builds on the GreenPerform family's reputation for reliable performance and robust design. With leading system efficacy, compact dimensions, and Unified Glare Rating (UGR) control, it ensures long-term quality in demanding industrial environments. Fully compatible with IoT platforms such as Interact, the G5 offers scalable, future-proof control. The range also includes cold-room variants designed for 100% humidity operation without condensation, making it versatile across almost all industrial applications.

Key features & benefits

- Automatic energy saving: PIR/MW sensing, daylight harvesting, and step-dimming functions
- High efficiency: Upgraded performance from 160 lm/W to 170 lm/W
- Flexible options: 3 sizes, 5 lumen packages, and 2 CCT variants
- Award-winning design: Red Dot Design Award 2022 recipient
- Simple energy savings: Automatic functions reduce consumption without complex setup
- Easy commissioning: Gateway, cloud, and app-free configuration
- Installation cost savings: Integrated wireless sensor eliminates need for separate components

Tango G4 LED Flood Lighting

The Philips Tango G4 LED floodlight is the 4th generation of the Tango family, engineered for higher efficacy, reduced weight, and optimised windage area. Designed for area and recreational sports lighting, it integrates the latest LED source, one-piece optical system, heat sink, and driver into a compact, robust housing that meets global safety standards. Its specially designed heat sink combines aesthetics with functionality, ensuring superior reliability and long lifetime performance.

Key features & Benefits

- High efficiency: Typical 140 lm/W system efficacy
- Versatile range: Multiple lumen packages for flood, area, and sports applications
- Flexible optics: Multiple optic options for tailored lighting design
- Durable construction: ADC1 diecast aluminum housing with steel bracket
- Reliability tested: ISO 9227 salt spray fog standard (500 hrs small/medium, 1000 hrs large housing)
- Protection: Rated IP66 and IK08 for harsh environments
- Energy savings: 10% more efficient than Tango G3
- Application coverage: Suitable for a wide range of outdoor lighting needs
- Optimised design: 23% less weight and 35% reduced windage area vs. Tango Gen3
- Enhanced environment: Brighter, safer, and more energetic lighting experience
- Robust reliability: Built for long-term performance in demanding conditions



Signify NatureConnect

Signify's NatureConnect lighting solution brings the benefits of natural daylight indoors, reconnecting people with the rhythms of nature. Built on the visual, biological, and emotional impact of natural light, NatureConnect mimics daylight patterns to create comfortable, engaging, and inspiring environments. By combining skylight, daylight, and lightscape elements, it delivers immersive experiences that enhance wellbeing, productivity, and spatial quality. With intuitive controls, users can select automatic day rhythm settings or tailor light scenes to specific activities, ensuring the right light at the right time.

Key features & benefits

- Daylight indoors: Mimics natural daylight cycles to support circadian rhythm and wellbeing
- Immersive skylight effect: Provides a realistic view to the sky, increasing spaciousness and connection to nature
- Dynamic lightscape: Natural colors and wall dynamics create engaging, restorative environments
- Flexible control: Automatic day rhythm or selectable natural light scenes via intuitive interface
- Integrated system: Combines LED luminaires, optics, and controls into a seamless solution
- Enhanced wellbeing: Supports alertness, reduces stress, and improves sleep quality
- Productivity boost: Provides the right light at the right time for work and relaxation
- Design versatility: Transforms windowless or dark spaces into inspiring environments
- Future-proof solution: Scalable and adaptable for offices, healthcare, education, and hospitality
- Natural connection: Creates a brighter, healthier, and more human-centric indoor experience



Benefits of BMS integration

- Centralised control: Facility managers can manage NatureConnect alongside HVAC, security, and other building systems.
- Energy optimisation: Occupancy and daylight sensors feed into BMS for automated energy savings.
- Human-centric scheduling: Circadian-supportive light recipes can be aligned with building-wide schedules.
- Scalability: Works across offices, healthcare, education, and hospitality environments, supporting both standalone and enterprise-level BMS setups.



How NatureConnect Integrates into BMS

1. Control protocols

DALI (Digital Addressable Lighting Interface): NatureConnect luminaires are designed to work with DALI-based systems, allowing precise dimming, scene control, and scheduling.

0–10V analog input: Integration with BMS can be facilitated via converters that translate DALI signals into 0–10V, ensuring compatibility with legacy systems.

2. System components

SNS210 IA sensor: Provides occupancy sensing, daylight harvesting, and task tuning at the luminaire level.

Xitanium Sensor Ready Bridge (SR Bridge): Acts as a gateway between NatureConnect luminaires and external control systems.

Digital-to-analog converter (e.g., WaveLinx Wired): Enables connection to BMS platforms that rely on analog inputs.

3. Software integration

Interact Pro app: Used for commissioning, scene setting, and ongoing control. It simplifies integration by offering cloud-free, app-based configuration.

Scene recipes: NatureConnect applies biologically effective light recipes (e.g., Day Rhythm, Energise, Relax) that can be triggered or scheduled via BMS integration.

4. Limitations & workarounds

No native BACnet support: NatureConnect does not directly support BACnet or PRF/PRA APIs.

Integration path: Achieved through DALI-to-analog bridges or via Interact software, ensuring compatibility with existing BMS infrastructure.

Johannesburg: Unit 4, Cambridge West, Cambridge Commercial Park, Witkoppen Road, Paulshof

Tel: + 27 (0) 11 646 5250

Cape Town: Unit 29, Creation Park, 2 Computer Rd, Montague Gardens (Marconi Beam) 7441

Tel: + 27 (0) 21 761 4525

info@rtsystems.co.za | www.rtsystems.co.za